

BALL TRANSFERS

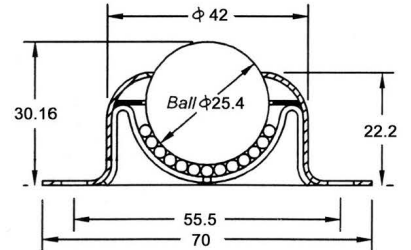

WSFI-25 - Flange Mounted
 This all steel column has a two-hole flanged base for easy mounting and is designed for ball-up application only.
Load Rating : 125 Lbs
Zinc Plated



WSFM-25 - Flange Mounted
 This all steel column has a two-hole flanged base for easy mounting and is designed for ball-up application only.
Load Rating : 125 Lbs
Zinc Plated

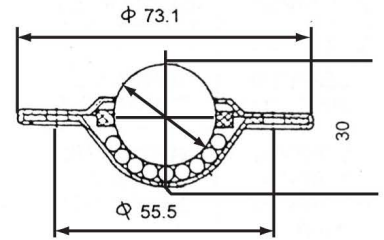

WSLM-25 - Stud Mounted
 Designed for multiple unit installation, these transfers have a drawn steel housing. The unit is engineered for ball up or ball down mounting.
Load Rating : 125 Lbs
Black Oxide

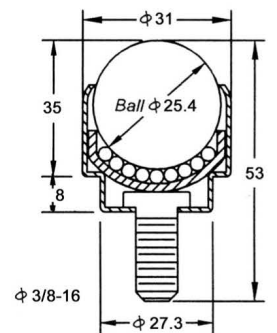

SPECIALS

BEARING UNITS



RUBBER CARTRIDGES

Light Duty
Eccentric Collar Locking

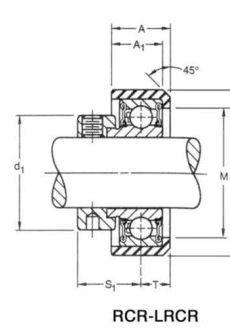
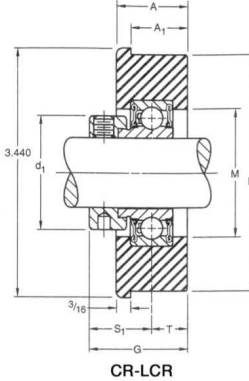
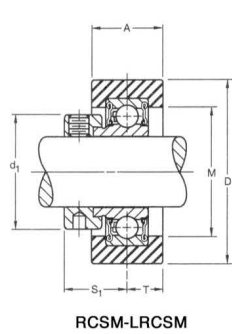

RSCM - LRCSM

RCR - LRCR

Also Available With Set Screw Locking, Add Suffix "S" - Example : RSCM-10S
Bearing No. CSB Instead of CSA

Unit No.	Shaft Dia.	Dimensions (mm)								Bearing No.	Rubber No.	Housing Radial Load Rating	Weight
	In.	D	A	A1	G	M	d1	S1	T				
RSCM SERIES													
RSCM-8	1/2	2-17/32	1	-	-	1-3/8	1-1/8	7/8	1/2	CSA 201-8	RSCM 40/65	200	0.87
RSCM-10	5/8	64.3	25.4	-	-	34.9	28.6	22.2	12.7	CSA 202-10		880	0.395
RSCM-12	3/4	2-17/32	1	-	-	1-9/16	1-5/16	59/64	1/2	CSA 204-12	RSCM 47/65	250	1.04
		64.3	25.4	-	-	39.7	33.3	23.4	12.7			1120	0.472
RSCM-14	7/8									CSA 205-14			
RSCM-15	15/16	2-17/32	1	-	-	1-25/32	1-1/2	59/64	1/2	CSA 205-15	RSCM 52/65	300	1.16
RSCM-16	1	64.3	25.4	-	-	45.2	38.1	23.4	12.7	CSA 205-16		1340	0.527
RSCM-17	1-1/16									CSA 206-17			
RSCM-18	1-1/8	3-3/32	1-3/16	-	-	1-7/8	1-3/4	1-3/32	19/32	CSA 206-18	RSCM 62/79	300	1.76
RSCM-19	1-3/16	78.6	30	-	-	48	44.4	27.7	15	CSA 206-19		1340	0.8
RSCM-20	1-1/4S									CSA 206-20			
LRCSM-19	1-3/16	2-17/32	1	-	-	1-7/8	1-21/32	25/32	1/2	CSA 106-19	RSCM 55/65	300	1.38
		64.3	25.4	-	-	47.6	42.1	19.8	12.7			1340	0.627
RCR SERIES													
LRCR-12	3/4	1-13/16	23/32	5/8	-	1-3/8	1-3/16	47/64	25/64	CSA 104-12	RCR 42/46	200	0.60
		46	18.3	15.9	-	34.9	30.2	18.7	9.9			880	0.272
RCR-16	1	2-1/4	25/32	11/16	-	1-3/4	1-1/2	59/64	25/64	CSA 205-16	RCR 52/57	300	0.90
		57.2	19.8	17.5	-	44.4	38.1	23.4	9.9			1340	0.409
CR SERIES													
CR-12	3/4	3.29	1	7/8	1-27/64	1-9/16	1-5/16	59/64	1/2	CSA 204-12	CR 47/83	150	0.70
		83.57	25.4	22.2	36.1	39.7	33.3	23.4	12.7			670	0.318
CR-16	1	3.29	1	7/8	1-27/64	1-25/32	1-1/2	59/64	1/2	CSA 205-16	CR 52/83	200	0.75
		83.57	25.4	22.2	36.1	45.2	38.1	23.4	12.7			880	0.340
LCR-16	1	3.29	1	13/16	1-5/16	1-9/16	1-27/64	25/32	9/16	CSA 105-16	CR 47/83	200	0.68
		83.57	25.4	20.6	33.3	39.7	36.1	19.8	14.3			880	0.309



TRAILER KITS



- | | |
|----------------|------------------------|
| K1000 : | Fitting 1" Axles |
| K1063 : | Fitting 1-1/16" Axles |
| K3500 : | Fitting 3500 Lbs Axles |

Everything you need for trailer wheel bearing replacement.

- Boat Trailers
- Snowmobiles
- Campers
- Utility Trailers
- Golf Carts

Each kit contains all parts for replacing 1 wheel bearing assembly

- 2- Roller bearings
- 1- Seal
- 1- Cotter pin
- 1- Grease pouch
- 1- Mounting instruction sheet